

## Risks - Social Control

Will monitoring technologies lead to ever greater surveillance, restrictions on mobility and other forms of social control?

Do all answers need some form of social control/influence?

Where is the line between wanting to do something and being made to do something?

Self-imposed surveillance vs external surveillance.

CHANGE THE WORLD? or  
CHANGE OURSELVES?

# geeKyoto eNotebook: your ideas on intervention and risk

geeKyoto 2008

JOB JENSEN LINDENBERG

8 7

= 2x Solar Power!

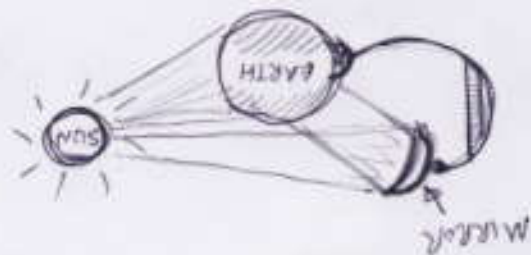

How can we power life on earth?

Interventions - Energy

geeKyoto 2008  
Living In The Changed World  
Saturday 17th May 2008, Conway Hall, London.

This eNotebook is a space for you to share your thoughts and ideas, observations and hopes, fears and aspirations for the future of the planet. The compass below suggests four different areas of intervention and risk. Use this eNotebook to write, doodle, scribble or draw your ideas on:

- **Interventions** you think can or should be made in the four areas (food, energy, economics and health) or others you think are missing;
- **Risks** from such interventions e.g.: social control, displaced consumption, 'Pyrrhic Victories' and resource conflict.

These eBooks will be collected up, scanned and made into a publicly accessible digital library to inform and help shape future geekyoto events.

2

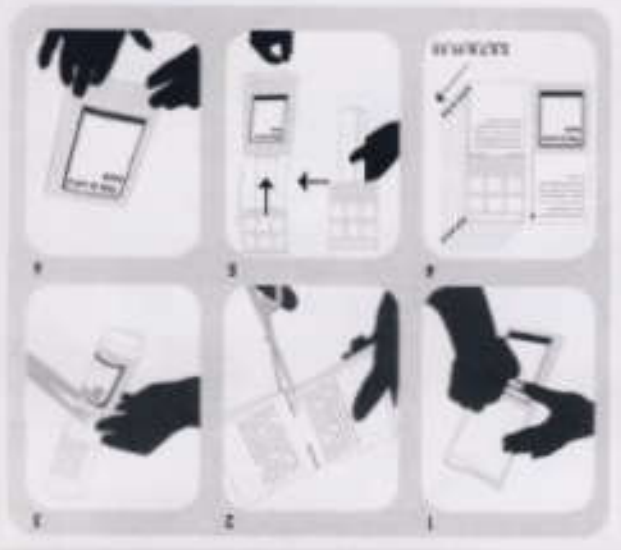

www.diffusion.org.uk  
 DIFFUSION ebooks are designed to be freely available to download, print out and share.

Created on: Mon Apr 14 14:38:38 2008

geekyoto 2008

geekyoto eNotebook: your ideas on intervention

or do we intentionally create conflict in order to boost the value of otherwise useless objects?  
 conflict → demand/status → increased value → profit

Are we facing new conflicts not only over resources (water, oil, raw materials etc) but also over the right to benefit from development?

Risks - Conflict

Your Name..... GRAHAM @ EXMOSIS.NET

Here are the key themes as we see them now, sometimes they are in opposition, other times not. What's missing from this matrix? Does each area deserve the same degree of attention and effort? Mark off how much you think each area should receive.

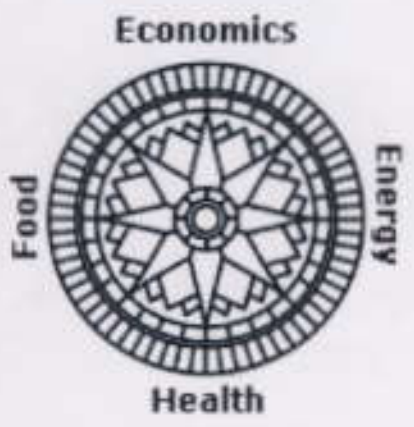

ON-LINE REACTIVITY, benefit and off-line benefits too.  
 VALUE = potential or additional  
 INDIVIDUAL - ?  
 → 'lack-in' (subscription)  
 → 'convenience' / EXTRACTION

SOCIAL + ?  
 → NEGOTIATION  
 → CONFLICT RESOLUTION

What is the bottom line for life on earth?

Interventions - Economics

## Risks - Pyrrhic Victories

Are we just inventing more polluting technologies to save us from the effects of industrialisation and the consumer society?

"Green" tech is 'shared' tech.  
to re-write ecology with community?  
shared experience?

where is All the social Hardware?

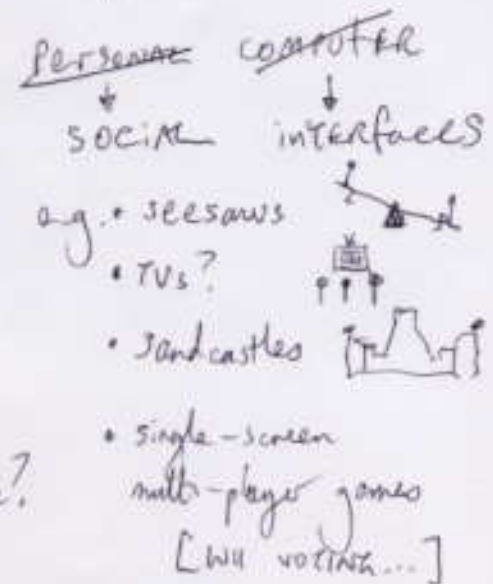

## Risks - Displaced Consumption

Are we just shifting the sites of production and consumption to somewhere else?

## Interventions - Health

How can we improve the health of life on earth?

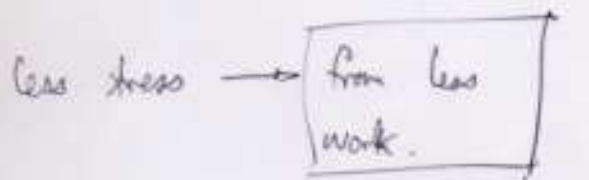

- Technology to teach skills:
  - instructables.com
  - competency-building? Does this work?
  - Connect those who want to learn something with those who can teach it.
    - or encourage learning/teaching amongst existing groups.

## Interventions - Food

How can we nourish life on earth?

